

Sanko's Full Bore Type Cartridge Ball Valve

三幸
全径型插装式
球阀
F型

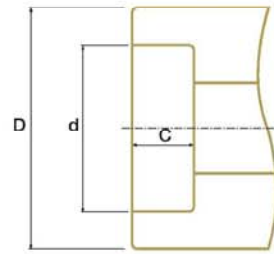

承插焊连接型端部尺寸表
Part dimension for socket welding under diameters of 50A

单位 Unit:mm

口径 Nominal size		d	D	C
A	B			
6	1/8	11.0	17	13
8	1/4	14.3	20	13
10	3/8	17.8	24	13
15	1/2	22.2	30	13
20	3/4	27.7	35	13
25	1	34.5	43	13
32	1-1/4	43.2	53	13
40	1-1/2	49.1	59	13
50	2	61.1	71	16

三幸插装式球阀的使用注意事项

- 选用满足使用要求的正确阀门。充分考虑使用流体、使用压力、使用温度、杂物的有无等。
 - 在进行安装阀门的配管时，确认阀门的介质流向后，安装至正确的方向。
 - 在进行安装阀门的配管时，尽可能地注意不要引起配管应力，进行正确的配管施工。
 - 阀门的保管，禁止在手轮中途启闭状态下的长期放置。否则可能会引起软阀座的塑性变形，导致阀座泄露。
 - 避免阀门在阀门前端的阀栓打开状态下的放置。当阀门中混入异物时，可能会造成阀座面、球体表面的损伤等，导致扭矩异常或阀座泄露。
 - 开始使用经过长期放置保存的阀门时，即便是正常的阀门也可能存在故障的情况。由于压盖部分的歪曲以及阀座面的粘着，生锈等原因，有时操纵手轮时会感到较为沉重。此种情况下，略微拧紧压盖螺母，以木锤等轻轻敲击手轮，略微使其振动，即可顺利运转。
 - 使用阀门时，通过采取预防性的维护保养措施可以延长阀门寿命，因此请勿忘记进行定期检查维修。
 - 按步骤正确进行拆卸、检修、组装。
- ※在订购阀门之际，请务必索取交货图纸。

USING YOUR SANKO'S CARTRIDGE TYPE BALL VALVE

- Only use materials which fit the valve's specifications. Carefully consider the material you choose and the pressure and temperature you use it, as well as if the material has particles in it.
 - Attach the valve properly to the direction the material will flow.
 - Do not force or use piping stress when attaching the valve and attach as per the instructions.
 - Do not leave the handle in a half open position for long periods of time. It could bend the seat and may cause leakage.
 - Avoid leaving the opening of the valve exposed for long periods of time. Outside materials may cause damage to the surface of the ball or seat and may lead to leakage from the valve.
 - As with any long term use valve, there may seem to be some problems when it is first attached. The handle may seem stiff due to rusting, the grand may rattle and the seat may seem stuck at times. At these times, retighten the grand nut, tap the handle with a wooden mallet or slightly tap the valve to fix the problem.
 - For long life of your valve, perform regular maintenance inspections. Always do periodic checks.
 - Always follow the correct order when assembling and disassembling your valve.
- ※Please Request Drawing when Planing Order for Valve.



F-type

 三幸金属株式会社

本社地址：邮编550-0004 大阪市西区初本町1丁目16番17号 电话：06-6441-6431(总机)

工厂地址：邮编639-0241 奈良县香芝市高188-1 电话：0745-78-4552(总机)

Main Office: Utsubo Honmachi 1-16-17, Nishi-ku, Osaka, 〒550-0004, Japan. TEL06-6441-6431 FAX06-6441-6548

Factory: Kashiba-Taka 188-1, Nara, 〒639-0241, Japan. TEL0745-78-4552 FAX0745-78-4562

SANKO METAL CO.,LTD.

实现成套设备配管系统的 省力化、合理化！

Ideal for Plant Pipe Systems!

持高温泥浆状流体！
Used for high temperature particle filled materials!

Sanko's
Full Bore Type
Cartridge Ball Valve

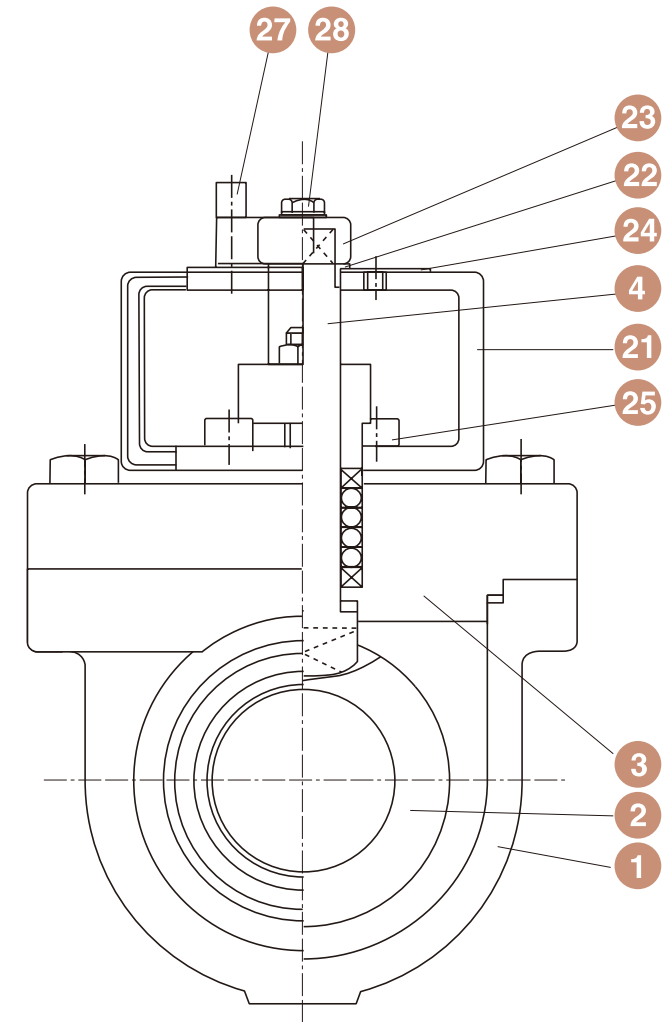

编号 NO.	零部件名称 PARTS NAME	数量 QNTY
1	阀体 BODY	1
2	球体 BALL	1
3	阀盖 COVER	1
4	阀杆 STEM	1
6	一次侧填料止动螺钉 1ST.SIDE RETAINER SEAT SET SCREW	1
7	调节环(固定环) SET RING	1
8	碟形弹簧 CONED DISK SPRING	1
9	一次侧填料止动螺钉 1ST.SIDE PACKING SET SCREW	1
10	一次、二次侧阀座后填料 1,2ND SIDE BUCK.PACKING	2SET
11	二次侧填料止动螺钉 2ND.SIDE RETAINER SEAT SET SCREW	1
12	二次侧填料止动螺钉 2ND.SIDE PACKING SET SCREW	1
13	环 RING	1
14	压盖填料 GLAND PACKING	1SET
15	密封垫片 GASKET	1
16	填料压盖 GLAND FRANGE	1
17	压盖螺栓 GLAND BOLTS	2
18	压盖螺母 GLAND NUTS	2
19	推力阀座 THRUST SEAT	1
20	阀盖螺栓 COVER BOLTS	8
21	阀盖 YOKE	1
22	手轮座衬套 HANDLE SEAT	1
23	手轮 HANDLE	1
24	阀门铭牌 NAME PLATE	1
25	阀盖固定螺栓 YOKE SET BOLTS	4
26	止动销 STOPPER PIN	1
27	手轮锁销 HANDLE LOCK PIN	1
28	带锁紧环的螺栓 BOLT/SW	1SET

高温金属铆接尺寸表
HIGH TEMPERATURE METALTOUCH TYPE DIMENSION LIST

呼径 Nominal size	记号 Mark	φP	φd	φD	L	H	HL
8A (1/4B)		8	9.4	13.8	116	100	130
10A (3/8B)		10	12.7	17.3	116	100	130
15A (1/2B)		15	16.1	21.7	165	110	130
20A (3/4B)		20	21.4	27.2	190	115	130
25A (1B)		25	27.2	34.0	216	120	130
32A (1.1/4B)		32	35.5	42.7	229	130	200
40A (1.1/2B)		40	41.2	48.6	241	145	200
50A (2B)		50	52.7	60.5	292	160	200
65A (2.1/2B)		60	65.9	76.3	330	200	300
80A (3B)		76	78.1	89.1	356	250	300
100A (4B)		102	102.3	114.3	432	300	300
125A (5B)		127	126.6	139.8	508	350	400
150A (6B)		152	151.6	165.2	559	400	400

* 上述为手动用阀门的标准尺寸。* 标注的壁厚尺寸以Sch40为标准。亦可支持Sch20、Sch80。
* 各种自动运转 还支持用于调整流量的V型球阀。* 50A以下的承插焊接尺寸表参见第11页。
* The above is the specifications for the manual valve. * The diameter of the opening is based on Sch40.It can also be used for dimensions of Sch 20 and Sch 80.
* It also applies for the volume control V-Notch seat and each automatic control. * please refer to page 11 for specific cations on socket welds below 50A.

维护简单！

- Easy Maintenance!
- 可在阀门本体连接配管情况下进行。
 - 拆卸、组装简单，无需特殊治具以及技术人员。
 - 设置后很长时间内（半永久性）无需进行更换。仅需修理、交换阀门内部组件的经济型设计。
 - 构造简单，同功能材料相配合，支持各种流体介质（高温、高压、耐磨耗、耐药品、耐腐蚀等）
 - 双密封结构，确保密封性万无一失。
 - Valve body easily serviced while attached to pipe systems.
 - Assembly and Disassembly is easily accomplished with no special tools or technicians.
 - No need to remove entire valve for long periods of time. Economical and practical since only middle section of valve requires regular maintenance and part replacement.
 - Applied use with many materials(high temperature,high pressure, erosive, chemical,corrosive)with its simple design and flexible applicability!
 - Sealing is perfect with its double seal structure.

绝对无压力损失的全通径型！！

- Full Bore Valve with Absolutely No Loss in Pressure !
- 电力规格设计！
Designed for Electric Standards!
- 支持超高温！
Perfect for High Temperatures!
- 绝对非石棉填料！！
Packing Entirely Non-Asbestos!
- 设计小巧轻便简单！
Compact and Simple Design!
- 消防安全设计！
Fire Safety Structure!

高温金属钎接尺寸表

级别 / 150 · 300 · 600

High Temperature Metal Touch
Class / 150 · 300 · 600

Sanko's
Full Bore Type
Cartridge Ball Valve

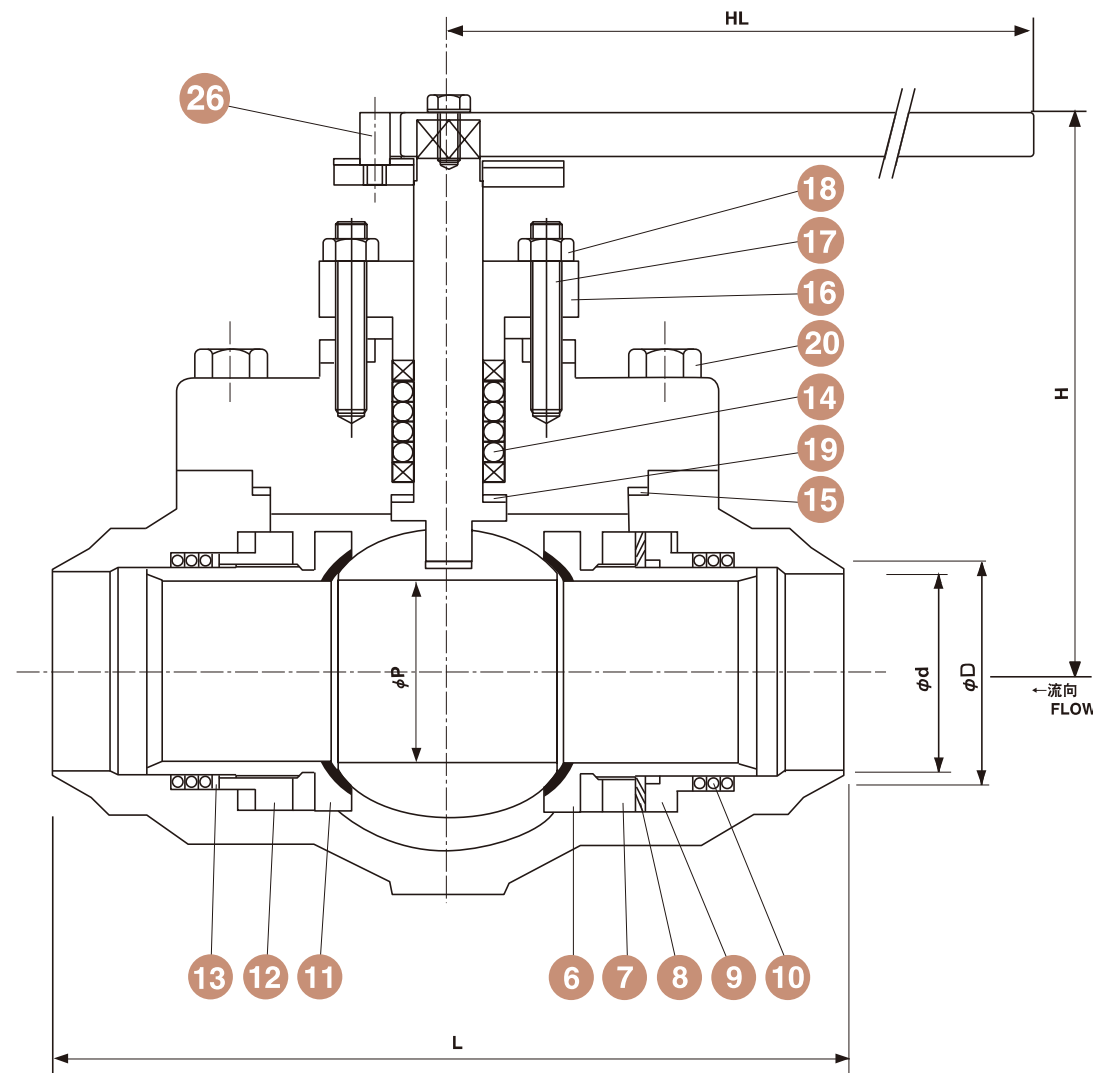

拆下阀盖螺栓，打开阀盖，逐渐松开固定环直至固定环两侧碰到阀座背面。
Remove cover bolt and lift off cover loosen both set rings until they come to the rear of the retainer.

●将治具杆或螺丝刀插入阀座外围小孔（沟槽）使其固定，将治具杆或螺丝刀插入固定环外围小孔（沟槽），慢慢松开治具直到固定环对准阀座背面。
Secure a screwdriver or the supplied stick in the notch on the outside of the seat. Insert screwdriver or another stick in the set ring until it reaches the rear of the retainer.

●取出球体时，必须顺着球体开启方向。
Insert screwdriver or another stick in the set ring until it reaches.

将固定环已经松开的两侧阀座分别插入一次侧、二次侧，使其与球体间产生空隙，取出球体。
Push each retainers with its loosened set rings in each flow direction. Mack a large enough space between them and the ball to slip the ball out.

●取出球体时，必须顺着球体开启方向。
Insert screwdriver or another stick in the set ring until it reaches.



取出球体后，沿着球体方向依次拉取出两侧的阀座。
After removing the ball, Take out each retainers starting from the closet to the ball's position.

●拆卸所卸下的各阀座的球座、O形环。
Always have the ball in its open position when removing it from the valve.

拆开阀盖组件，拆卸工作全部完成。
Disassembly of the cover assembly is now complete.

检修各零部件之际，尤其需要检查球体、阀座垫、O形环等是否有损伤、以及磨损的程度。发现损伤、磨损等情况，应更换新的零部件。若未发现存在异常情况，则仅需进行清洗并重新组装。
When inspecting each piece, check for any scratches or erosion on the ball, valve seat and O ring. Replace scratched or eroded parts with new ones. If no problems exist, reassemble after carefully cleaning and rinsing each part.

高温金属钎接阀门规格

HIGH TEMPERATURE METAL TOUCH TYPE APPLICATION

使用压力 (MPa) WORKING PRESSURE	使用温度 (°C) WORKING TEMPE	阀体材质 BODY MATERIAL	球体材质 BALL MATERIAL	阀座材质 VALVE SEAT MATERIAL	使用流体 WORKING FLUID
MAX.9.9 (常温时)	-40~250	SCPH2,SCS13A	硬质镀铬处理 HARD CHROMEPLATED SUS304	司太立合金 (Stellite) STELLITE PLATED SUS304	泥浆状 参杂固体物的高温气体、空气、油、燃烧气体、 高温高压水 等 GAS WITH HEATED PATICLES, AIR, OIL, COOKS GAS, WATER AT HIGH PRESSURE etc. HIGH PRESSURE etc. PARTICLE FILLED MATERIALS
MAX.6.1 (250摄氏度时)	-40~500	SCS14A,16A	SUS316,316L 司太立合金 (Stellite) STELLITE PLATED	SUS316,316L 司太立合金 (Stellite) STELLITE PLATED	

拆卸、组装简单 & 快速！

Assembly and Disassembly is Speedy and Easy!

标准型

级别 / 150 · 300 · 600

Standard Type
Class / 150 · 300 · 600

支持从高温到超高温的各种温度！
[燃烧气体、高温蒸汽、高温N₂、阳极气体等]
Used for high to super high temperatures!
[combustible gases · high temperature steam · high temperature N₂ · anode gas]

Sanko's Full Bore Type Cartridge Ball Valve

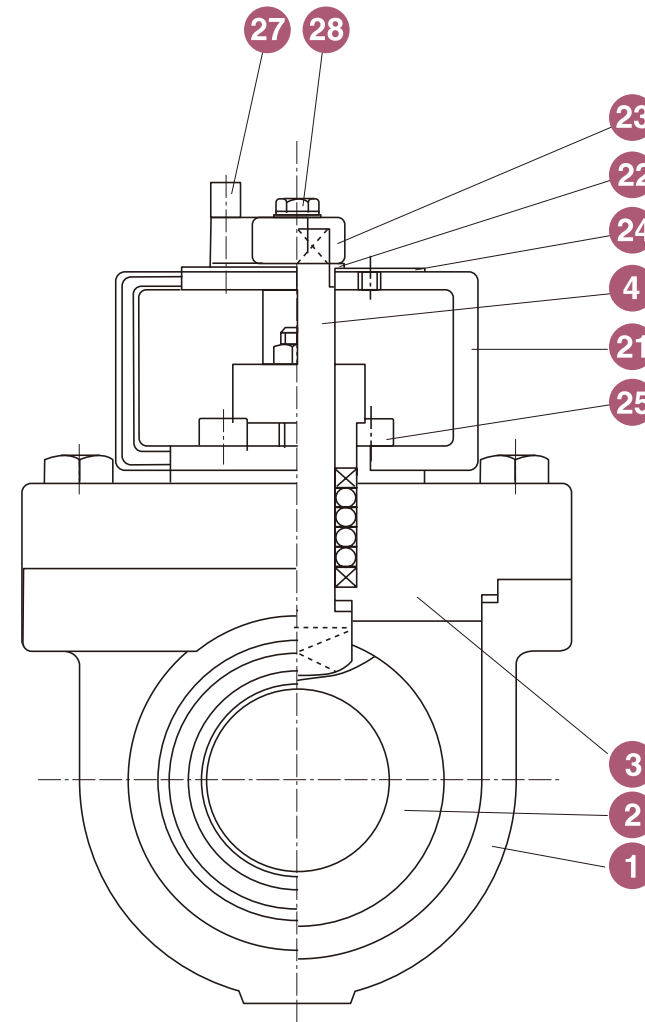
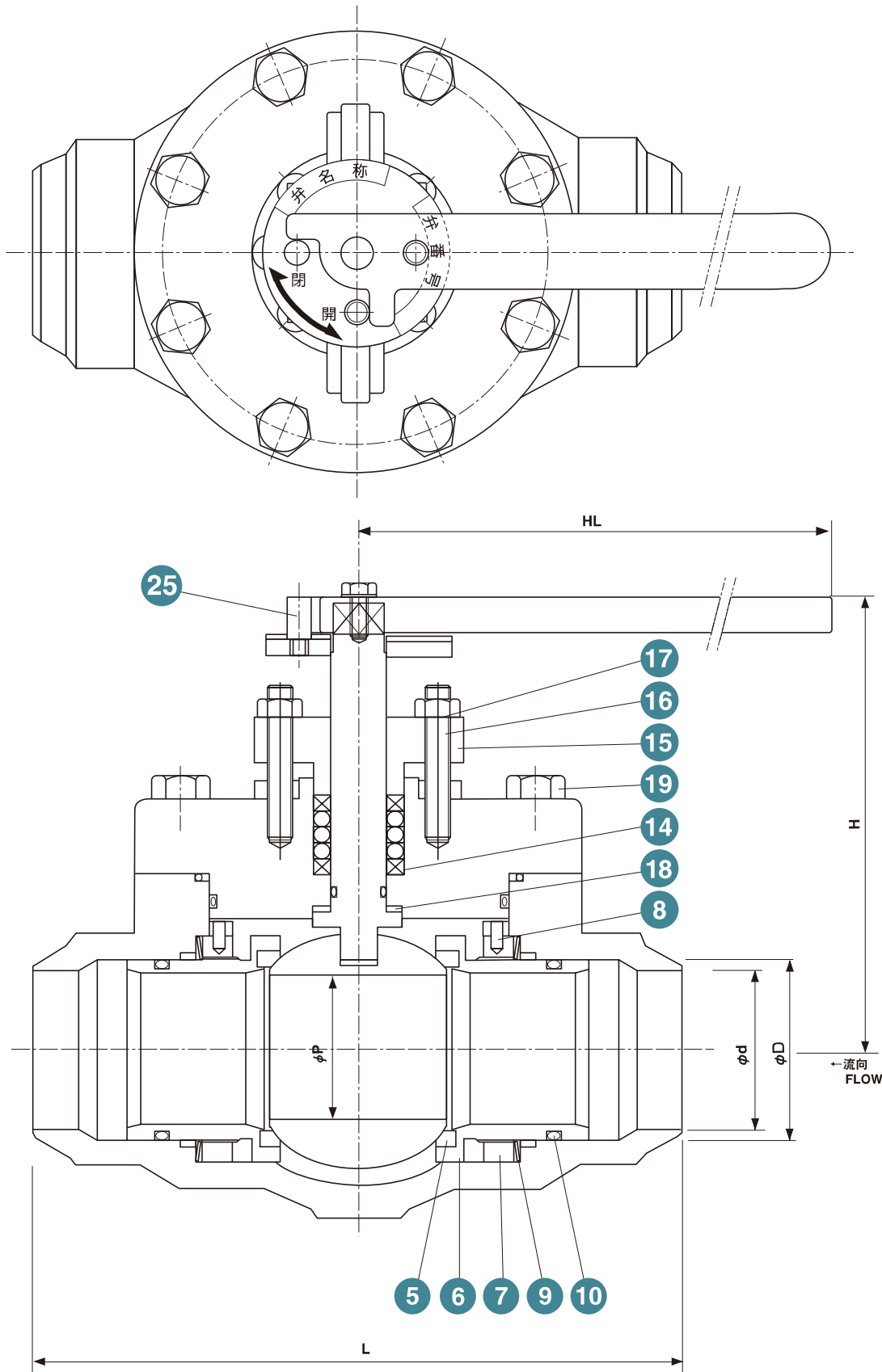

编号 NO.	零部件名称 PARTS NAME	数量 QNTY
1	阀体 BODY	1
2	球体 BALL	1
3	阀盖 COVER	1
4	阀杆 STEM	1
5	球座 BALL SEAT	2
6	一次侧阀座 1ST.SIDE RETAINER	1
7	固定环 SET RING	1
8	碟形弹簧 CONED DISK SPRING	1
9	一次侧填料止动螺钉 1ST.SIDE PACKING SET SCREW	1
10	一次、二次侧阀座后填料 1,2ND SIDE GUCK.PACKING	2SET
11	二次侧板阀座 2ND.SIDE RETAINER	1
12	二次侧填料止动螺钉 2ND.SIDE PACKING SET SCREW	1
13	环 RING	1
14	压盖填料 GLAND PACKING	1SET
15	密封垫片 GASCKET	1
16	填料压盖 GLAND FRANGE	1
17	压盖螺栓 GLAND BOLTS	2
18	压盖螺母 GLAND NUTS	2
19	推力阀座 THRUST SEAT	1
20	阀盖螺栓 COVER BOLTS	8
21	阀轭 YOKE	1
22	手轮座衬套 HANDLE SEAT	1
23	手轮 HANDLE	1
24	阀门铭牌 NAME PLATE	1
25	阀轭固定螺栓 YOKE SET BOLTS	4
26	止动销 STOPPER PIN	1
27	手轮锁销 HANDLE LOCK PIN	1
28	带锁紧环的螺栓 BOLT/SW	1SET

高温用尺寸表

HIGH TEMPERATURE DIMENSION LIST

单位 Unit:mm (inch)

口径 Nominal size	记号Mark	φP	φd	φD	L	H	HL
8A (1/4B)		8	9.4	13.8	116	100	130
10A (3/8B)		10	12.7	17.3	116	100	130
15A (1/2B)		15	16.1	21.7	165	110	130
20A (3/4B)		20	21.4	27.2	190	115	130
25A (1B)		25	27.2	34.0	216	120	130
32A (1.1/4B)		32	35.5	42.7	229	130	200
40A (1.1/2B)		40	41.2	48.6	241	145	200
50A (2B)		50	52.7	60.5	292	160	200
65A (2.1/2B)		60	65.9	76.3	330	200	300
80A (3B)		76	78.1	89.1	356	250	300
100A (4B)		102	102.3	114.3	432	300	300
125A (5B)		127	126.6	139.8	508	350	400
150A (6B)		152	151.6	165.2	559	400	400

* 上述为手动阀门的标准尺寸。* 标注的壁厚尺寸以Sch40为标准。亦可支持Sch20、Sch80。

* 各种自动运转 还支持用于调整流量的V型球阀。* 50A以下的承插焊接尺寸表参见第11页。

※The above is the specifications for the manual valve. ※The diameter of the opening is based on Sch40.It can also be used for dimensions of Sch 20 and Sch 80.

※It also applies for the volume control V-Notch seat and each automatic control. ※please refer to page 11 for specific cations on socket welds below 50A.

高温用(最高600°C)

级别 / 150 · 300 · 600

High Temperature Maximum 600°C
Class / 150 · 300 · 600

Sanko's Full Bore Type Cartridge Ball Valve

标准型阀门规格 STANDARD APPLICATION

使用压力 (MPa) WORKING PRESSURE	使用温度 (°C) WORKING TEMPE	阀体材质 BODY MATERIAL	球体材质 BALL MATERIAL	阀片材质 VALVE SEAT MATERIAL	使用流体 WORKING FLUID
MAX.9.9	-40~180	SCPH2,SCS13A	SUS304硬质镀铬 HARD CHROMEPLATED	REINFORCED PTFE, or,PEEK450G	气体、空气、水、油、蒸汽 GAS,AIR,WATER,OIL,STEAM
		SCS14A	SUS316		气体、空气、水、油、腐蚀性流体 GAS,AIR,OIL,STEAM,COROSIVE FLUID
		SCS16A	SUS316L		气体、空气、水、油、腐蚀性流体 GAS,AIR,OIL,STEAM,COROSIVE FLUID
		SCS19A	SUS304L		气体、空气、水、油、腐蚀性流体 GAS,AIR,OIL,STEAM,COROSIVE FLUID
		SCS10	SUS329J1		海水、腐蚀性流体 SEA WATER,COROSIVE FLUID

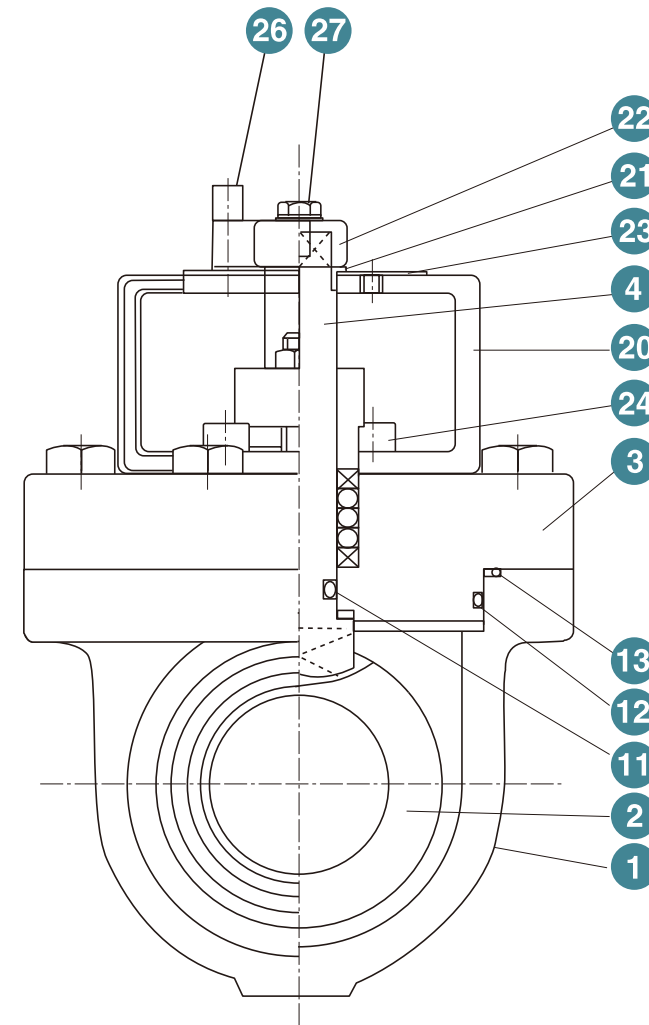
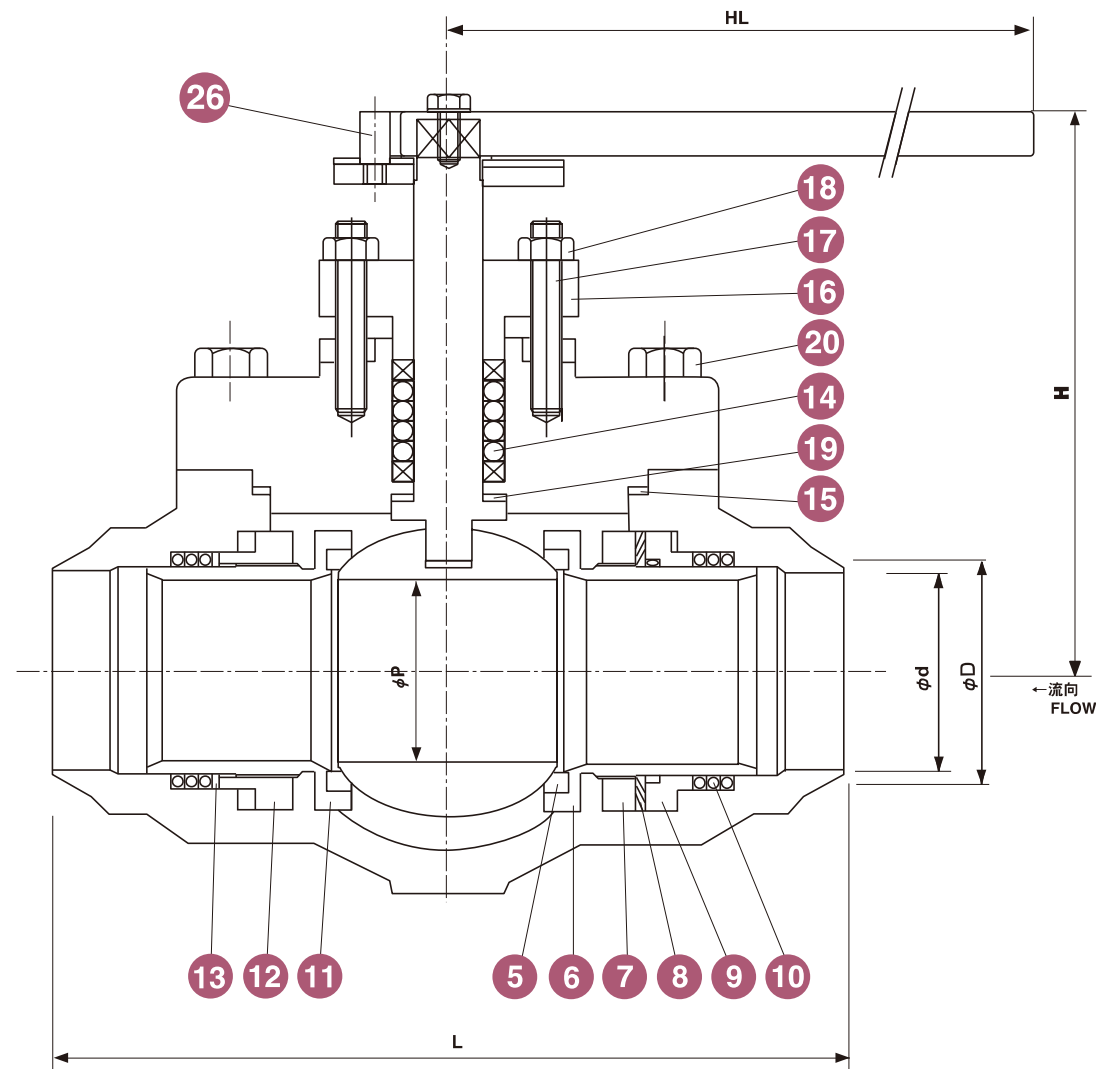

支持高温使用的阀门规格 HIGH TEMPERATURE TYPE APPLICATION

使用压力 (MPa) WORKING PRESSURE	使用温度 (°C) WORKING TEMPE	阀体材质 BODY MATERIAL	球体材质 BALL MATERIAL	阀片材质 VALVE SEAT MATERIAL	使用流体 WORKING FLUID
MAX.9.9 (常温时)	-40~600	SCPH2,SCS13A	SUS304	碳或碳陶瓷 CARBON or CARBON CERAMICS	高温蒸汽、高温气体、高温空气、燃烧气体、 高温高压水 等 STEAM & GAS & AIR AT HIGH TEMPERATURE COMBUSTIBLE GAS, WATER AT HIGH TEMPERATURE & PRESSUER etc.
MAX.5.6 (350摄氏度时)	-40~250	SCS14A,16A	SUS316,316L 司太立合金(Stellite) STELLITED PLATED	SUS316,316L司太立合金(Stellite) STELLITED PLATED	

编号 NO.	零部件名称 PARTS NAME	数量 QNTY
1	阀体 BODY	1
2	球体 BALL	1
3	阀盖 COVER	1
4	阀杆 STEM	1
5	球座 BALL SEAT	2
6	阀座 RETAINER	2
7	固定环 SET RING	2
8	固定环锁销 SET RING LOCK PIN	2
9	碟形弹簧 CONED DISK SPRING	2
10	O形圈 O-RING	2
11	O形圈 O-RING	1
12	O形圈 O-RING	1
13	金属O形圈 METAL O-RING	1
14	压盖填料 GLAND PACKING	1SET
15	填料压盖 GLAND FLANGE	1
16	压盖螺栓 GLAND BOLTS	1
17	压盖螺母 GLAND NUTS	1
18	推力阀座 THRUST SEAT	2
19	阀盖螺栓 COVER BOLTS	8
20	阀驱 YOKE	1
21	手轮座衬套 HANDLE SEAT BUSH	1
22	手轮 HANDLE	1
23	阀门铭牌 NAME PLATE	1
24	阀驱固定螺栓 YOKE SET BOLTS	4
25	止动销 STOPPER PIN	1
26	手轮锁销 HANDLE LOCK PIN	1
27	带锁紧环的螺栓 BOLT/SW	1SET

金属钎接

级别 / 150 · 300 · 600

Metal Touch

Class / 150 · 300 · 600

支持泥浆状流体(掺杂固体的气体、液体燃料等)！
Used for particle filled gases (hard particle filled gases, liquid fuel)!

Sanko's
Full Bore Type
Cartridge Ball Valve

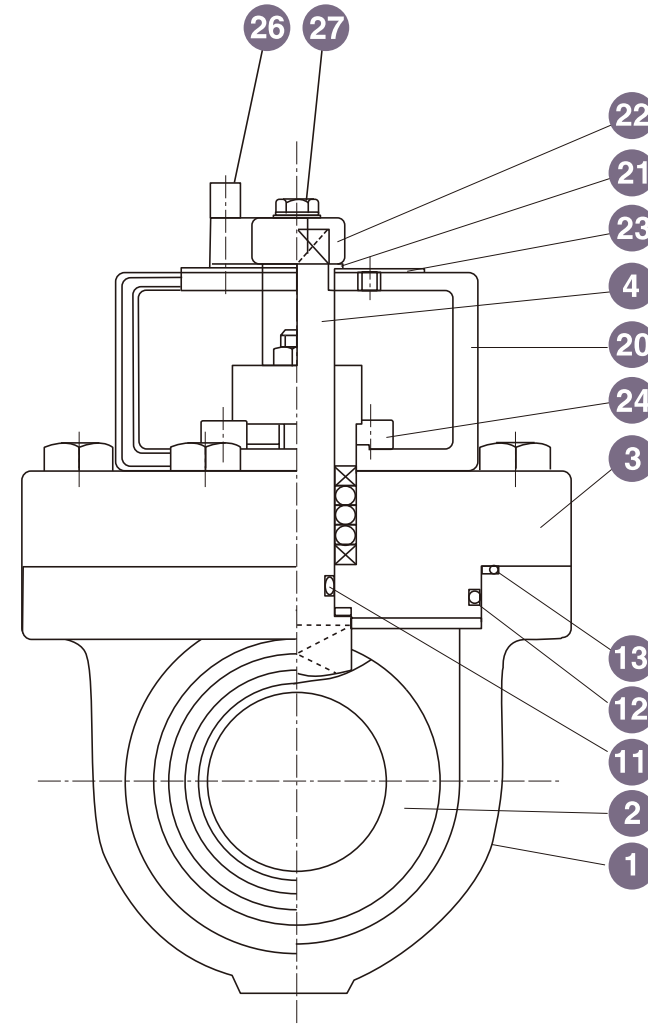
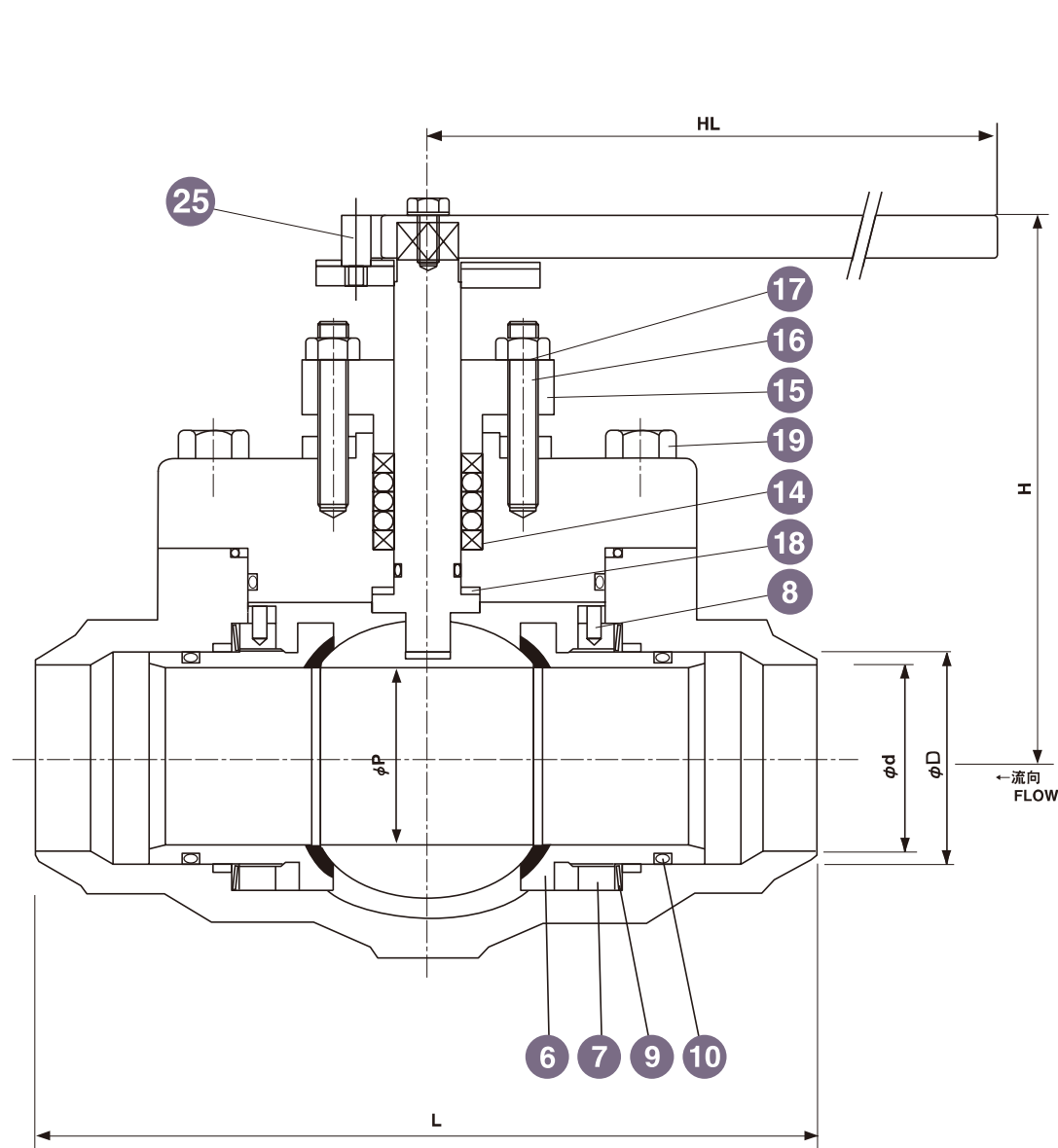

编号 NO.	零部件名称 PARTS NAME	数量 QNTY
1	阀体 BODY	1
2	球体 BALL	1
3	阀盖 COVER	1
4	阀杆 STEM	1
6	阀座垫 RETAINER SEAT	2
7	固定环 SET RING	2
8	固定环锁销 SET RING LOCK PIN	2
9	碟型弹簧 CONED DISK SPRING	2
10	O形环(密封圈) O-RING	2
11	O形环(密封圈) O-RING	1
12	O形环(密封圈) O-RING	1
13	金属密封圈 METAL O-RING	1
14	压盖填料 GLAND PACKING	1SET
15	填料压盖 GLAND FLANGE	1
16	压盖螺栓 GLAND BOLTS	1
17	压盖螺母 GLAND NUTS	1
18	推力阀座座 THRUST SEAT	2
19	阀套螺栓 COVER BOLTS	8
20	阀轭 YOKE	1
21	手轮座衬套 HANDLE SEAT BUSH	1
22	手轮 HANDLE	1
23	阀门铭牌 NAME PLATE	1
24	阀轭固定螺栓 YOKE SET BOLTS	4
25	带锁紧环的止动销 STOPPER PIN	1
26	手轮锁销 HANDLE LOCK PIN	1
27	带锁紧环的螺栓 BOLT/SW	1SET

金属钎接阀门规格

METAL TOUCH TYPE APPLICATION

使用压力 (MPa) WORKING PRESSURE	使用温度 (°C) WORKING TEMPE	阀体材质 BODY MATERIAL	球体材质 BALL MATERIAL	阀片材质 VALVE SEAT MATERIAL	使用流体 WORKING FLUID
MAX.9.9	-40~180	SCPH2,SCS13A	SUS304	SUS304司太立合金 (Stellite) STELLITE PLATED	泥浆状一般流体 PARTICLE FILLED MATERIALS
		SCS14A,SCS16A	SUS316,316L 硬质镀铬处理 HARD CHROMEPLATED	SUS304司太立合金 (Stellite) STELLITE PLATED	泥浆状腐蚀性流体 PARTICLE FILLED MATERIALS

标准型·金属钎接尺寸表

STANDERD · METALTOUCH TYPE DIMENSION LIST

单位 Unit:mm (inch)

呼径 Nominal size	记号 Mark	φP	φd	φD	L	H	HL
8A (1/4B)		8	9.4	13.8	116	90	130
10A (3/8B)		10	12.7	17.3	116	90	130
15A (1/2B)		15	16.1	21.7	165	95	130
20A (3/4B)		20	21.4	27.2	190	100	130
25A (1B)		25	27.2	34.0	216	105	130
32A (1.1/4B)		32	35.5	42.7	229	110	200
40A (1.1/2B)		40	41.2	48.6	241	145	200
50A (2B)		50	52.7	60.5	292	160	200
65A (2.1/2B)		60	65.9	76.3	330	200	300
80A (3B)		76	78.1	89.1	356	250	300
100A (4B)		102	102.3	114.3	432	300	300
125A (5B)		127	126.6	139.8	508	350	400
150A (6B)		152	151.6	165.2	559	400	400

* 上述为手动阀门的标准尺寸。* 标注的壁厚尺寸以Sch40为标准。亦可支持Sch20、Sch80。
* 各种自动运转 还支持用于调整流量的V型球阀。* 50A以下的承插焊接尺寸表参见第11页。

※The above is the specifications for the manual valve. ※The diameter of the opening is based on Sch40.It can also be used for dimensions of Sch 20 and Sch 80.
※It also applies for the volume control V-Notch seat and each automatic control. ※please refer to page 11 for speciations on socket welds below 50A.